

# APS (Auto Pumping System) User's Manual

Ver. 1.0

※ APS (Auto Pumping System) has been upgraded for better product performance.  
Please refer to this manual for use.

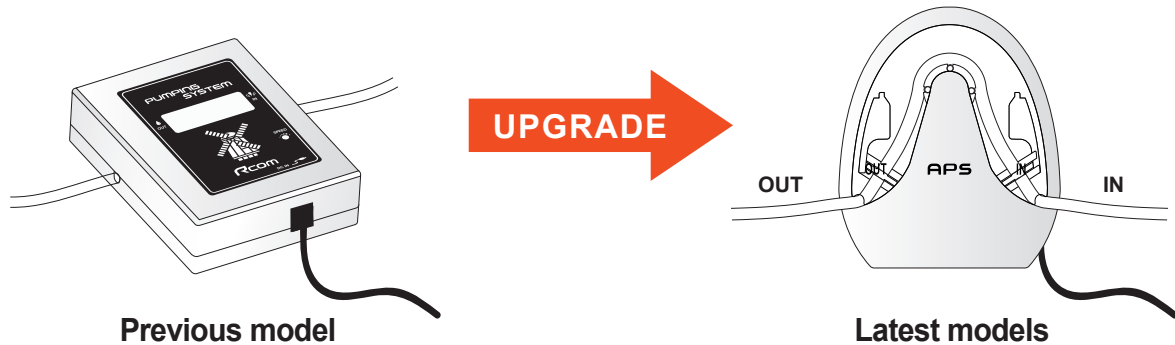

## APS Components

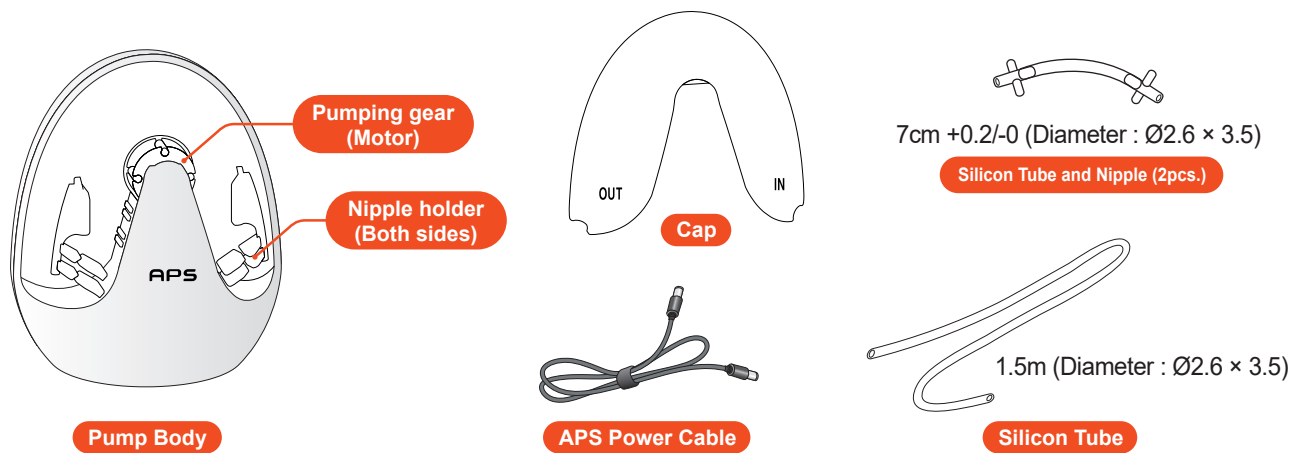

## How to Assemble APS (Automatic Pumping System)

**!** The silicone tube may become folded, causing a blockage. Please ensure that any blockages are removed by gentle pulling both ends of the tube before assembly.

**1** Cut the silicone tube to 1m and 0.5m lengths.

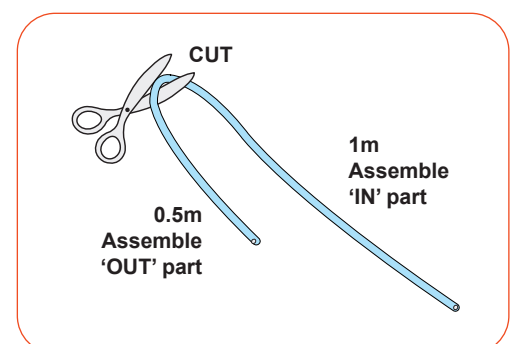

- 2** Attach the cut parts of the silicone tube onto the nipples on either side of the APS unit.

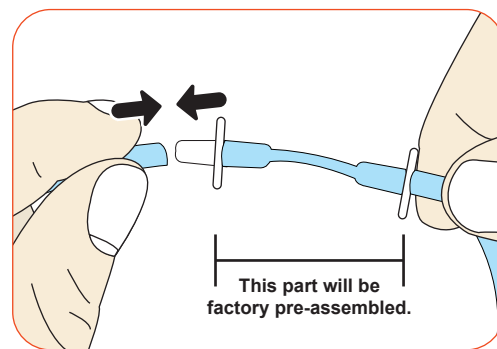

- !** Please note that pumping performance will be reduced if the silicone tube isn't fitted tightly onto the nipple, or if the tube length is different from [Picture A].

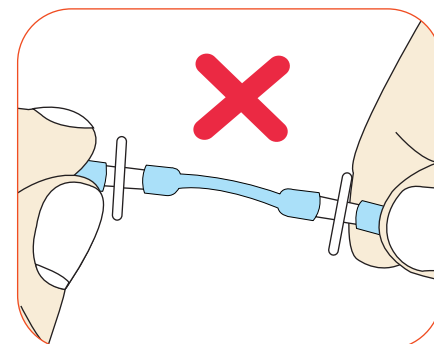
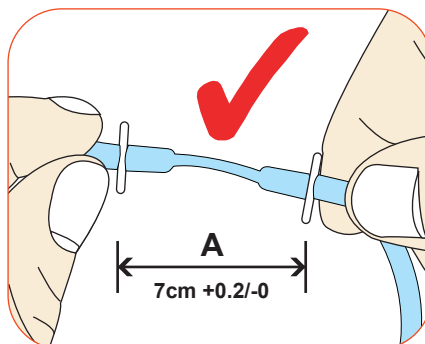

- 3** As shown in [Picture B], insert a nipple, attached to 0.5m silicone tube, into the 'OUT' part (left-hand side) of the nipple holder.

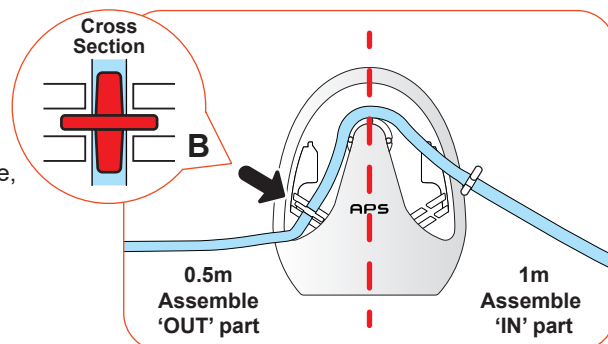

- 4** As shown in [Picture C], insert a nipple, attached to 1m silicone tube, into the 'IN' part (right-hand side) of the nipple holder.

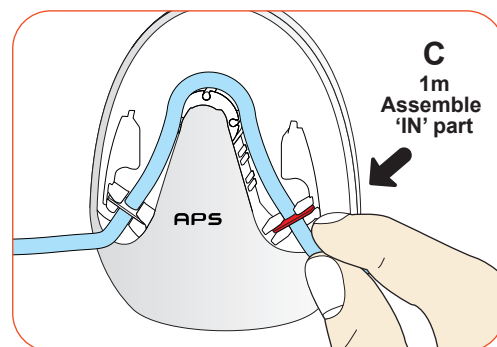

- 5** Assemble the cap onto the pump body. Please make sure silicone tubes do not get jammed in the cap.

- 6** Connect the APS power cable onto the power inlet at the back of the pump body.

- 7** Please refer to booklet manual page 16 for how to assemble the APS with the incubator.

- Tip** As shown, water flows out of the left silicon tube, and comes into the right silicon tube.

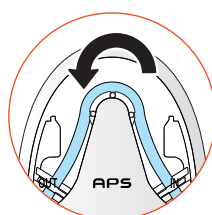

Turning direction of the motor

